

Y 1 2 0 A L A

Signatures and seals only

THE COMMON SEAL OF
was heretofore affixed by authority of a resolution of the Board of Directors in the presence of
Secretary

THE COMMON SEAL OF
Secretary

THE OFFICIAL SEAL OF THE REGISTRAR GENERAL FOR NEW SOUTH WALES
is hereby placed on this plan in accordance with the provisions of section 111 of the Survey Act, 1924, as amended, in accordance with the Survey Practice Regulations, 1932, and was completed on 1st DECEMBER, 1977.

By the Registrar General for New South Wales
I, Bruce Richard Davies, Registrar General for New South Wales, certify that this negative is a permanent record of a document in my custody this 23rd day of August, 1977.

These results may differ substantially from the current NSW LRS records. These results must not be used for commercial purposes.

Warning : The following search results refer to NSW LRS Test data only. These results may differ substantially from the current NSW LRS records. These results must not be used for commercial purposes.

Warning : The following search results refer to NSW LRS Test data only. These results may differ substantially from the current NSW LRS records. These results must not be used for commercial purposes.

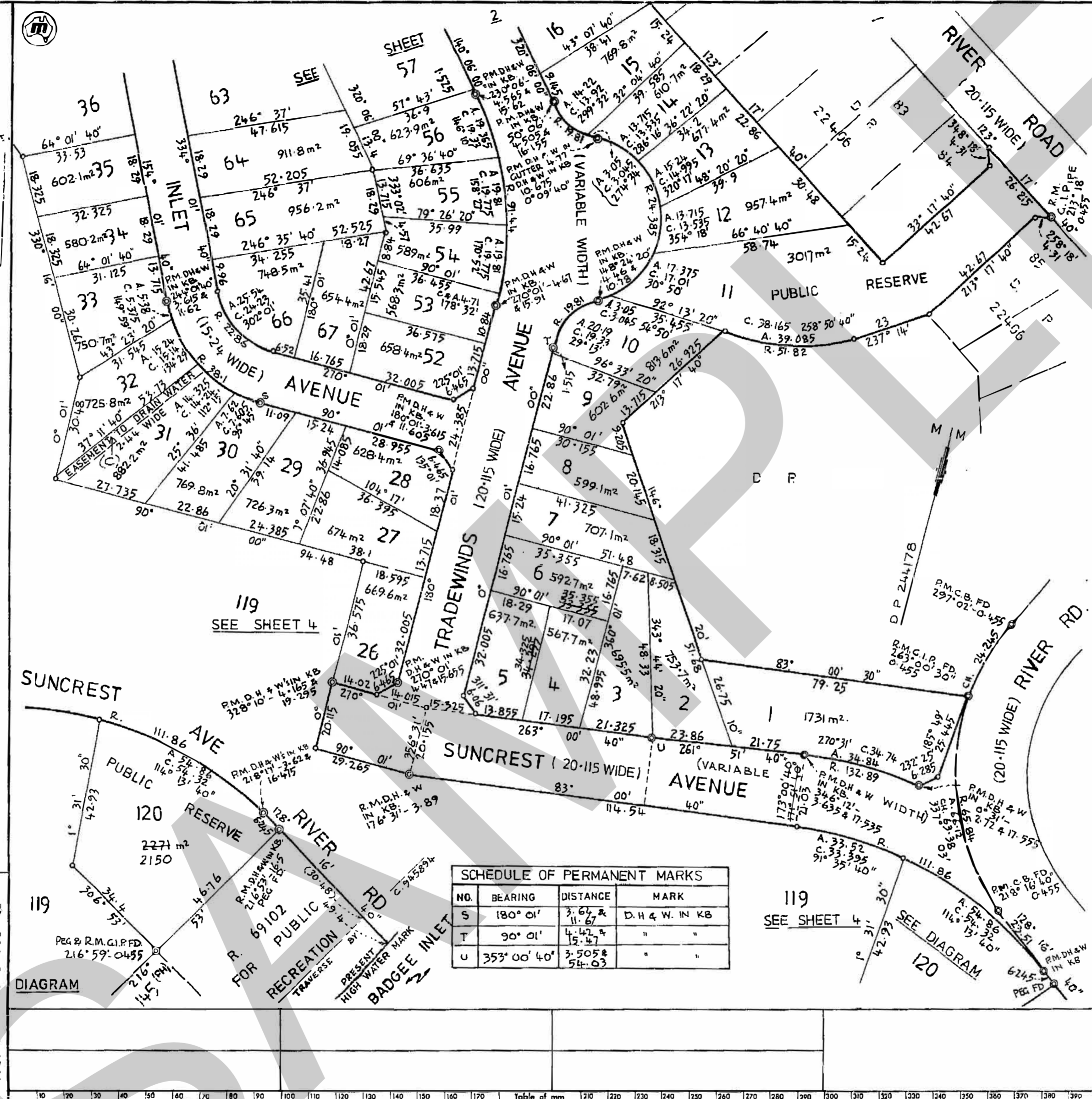

Registered: [Redacted]

C.A. NO 2521 OF 18-12-1972

Title System: TORRENS

Purpose: SUBDIVISION

Ref. Map: PARISH

Last Plan: D P

PLAN SUBDIVISION OF [Redacted]

Reduction Ratio 1: 800
Lengths are in metres.

Mun/Shire City: SHOALHAVEN

Locality: SUSSEX INLET

Parish: FARNHAM

County: ST VINCENT

This is sheet 1 of my plan in 4
(Delete if inapplicable).

Signature: [Redacted]

Surveyor registered under Surveyors Act, 1924, as amended.
District of ADAMSBURGH (SHEET 3)
*Strike out either (1) or (2). Insert date of survey.

Panel for use only for statements of intention to dedicate public roads or to create public reserves, drainage reserves, easements or restrictions as to user.

IT IS INTENDED TO DEDICATE THE ROADS 20.115 WIDE, 15.24 WIDE AND VARIABLE WIDTH AND THE PATHWAY 3.66 WIDE SHOWN HEREON TO THE PUBLIC.

PURSUANT TO SECTION 88B OF THE CONVEYANCING AMENDMENT ACT 1919-1964 IT IS INTENDED TO CREATE:-

- EASEMENT TO DRAIN WATER 2.44 WIDE.
- RESTRICTIONS AS TO USER.

IT IS INTENDED TO CREATE LOTS 11, 68 & 120 AS PUBLIC RESERVE.

INSTRUMENT FILED AS N99731

SLAVEYOR'S REFERENCE: 4099-1D1

WARNING: CREASING OR FOLDING WILL LEAD TO REJECTION

0	10	20	30	40	50	60	70	80	90	100	110	120	130	140	150	160	170	180	190	200	210	220	230	240	250	260	270	280	290	300	310	320	330	340	350	360	370	380	390	400
---	----	----	----	----	----	----	----	----	----	-----	-----	-----	-----	-----	-----	-----	-----	-----	-----	-----	-----	-----	-----	-----	-----	-----	-----	-----	-----	-----	-----	-----	-----	-----	-----	-----	-----	-----	-----	-----

I, Bruce Richard Davies, Registrar General for New South Wales, certify that this negative is a permanent record of a document in my custody this 23rd day of August, 1977.

[Signature]

1

Warning :
The following search results refer
to NSW IRS Test data only.

These results may differ substantially
from the current NSW IRS records.

These results must not be used for
commercial purposes.

PLAN FORM 3 To be used in conjunction with Plan Form 2

WARNING: CREASING OR FOLDING WILL LEAD TO REJECTION

OFFICE USE ONLY

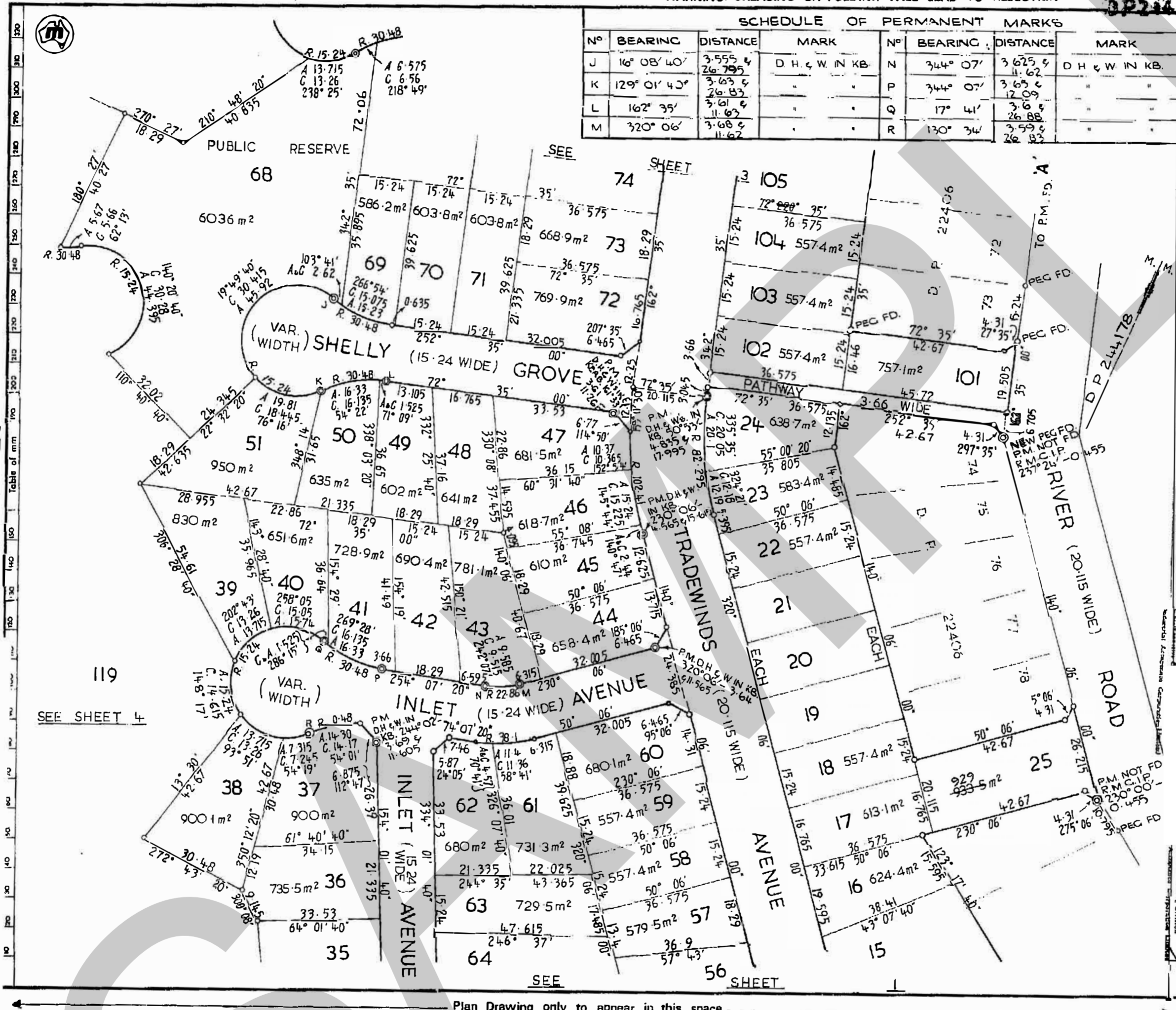

SCHEDULE OF PERMANENT MARKS							
N°	BEARING	DISTANCE	MARK	N°	BEARING	DISTANCE	MARK
J	16° 08' 40"	26.795	D H & W IN KB	N	344° 07'	3.625	D H & W IN KB
K	129° 01' 43"	26.83	"	P	344° 07'	3.63	"
L	162° 35'	11.62	"	Q	17° 41'	26.88	"
M	320° 06'	11.62	"	R	130° 34'	26.83	"

Registered: **DP 244178**

This is sheet 2 of my plan of 4 sheets dated **1st DECEMBER, 1972**.

Surveyor registered under Surveyors Act 1929

This is sheet 2 of the plan of 4 sheets covered by my Certificate No. **2521** of 18.12.72.

Signatures and seals only.

THE REGISTRAR GENERAL SEAL of the Registrar-General for New South Wales

was hereunto affixed by authority of a resolution of the Board of Directors in

Secretary

Reduction Ratio 1:800

SURVEYOR'S REFERENCE 4099-1D1

1. Bruce Richard Davis, Registrar General for New South Wales, certify that this negative is a photograph made as a permanent record of a document in my custody this 23rd day of August, 1977

Bruce Richard Davis

Warning :
 The following search results refer to NSW LRS Test data only.

These results may differ substantially from the current NSW LRS records.

These results must not be used for commercial purposes.

PLAN FORM 3 To be used in conjunction with Plan Form 2

WARNING: CREASING OR FOLDING WILL LEAD TO REJECTION

OFFICE USE ONLY

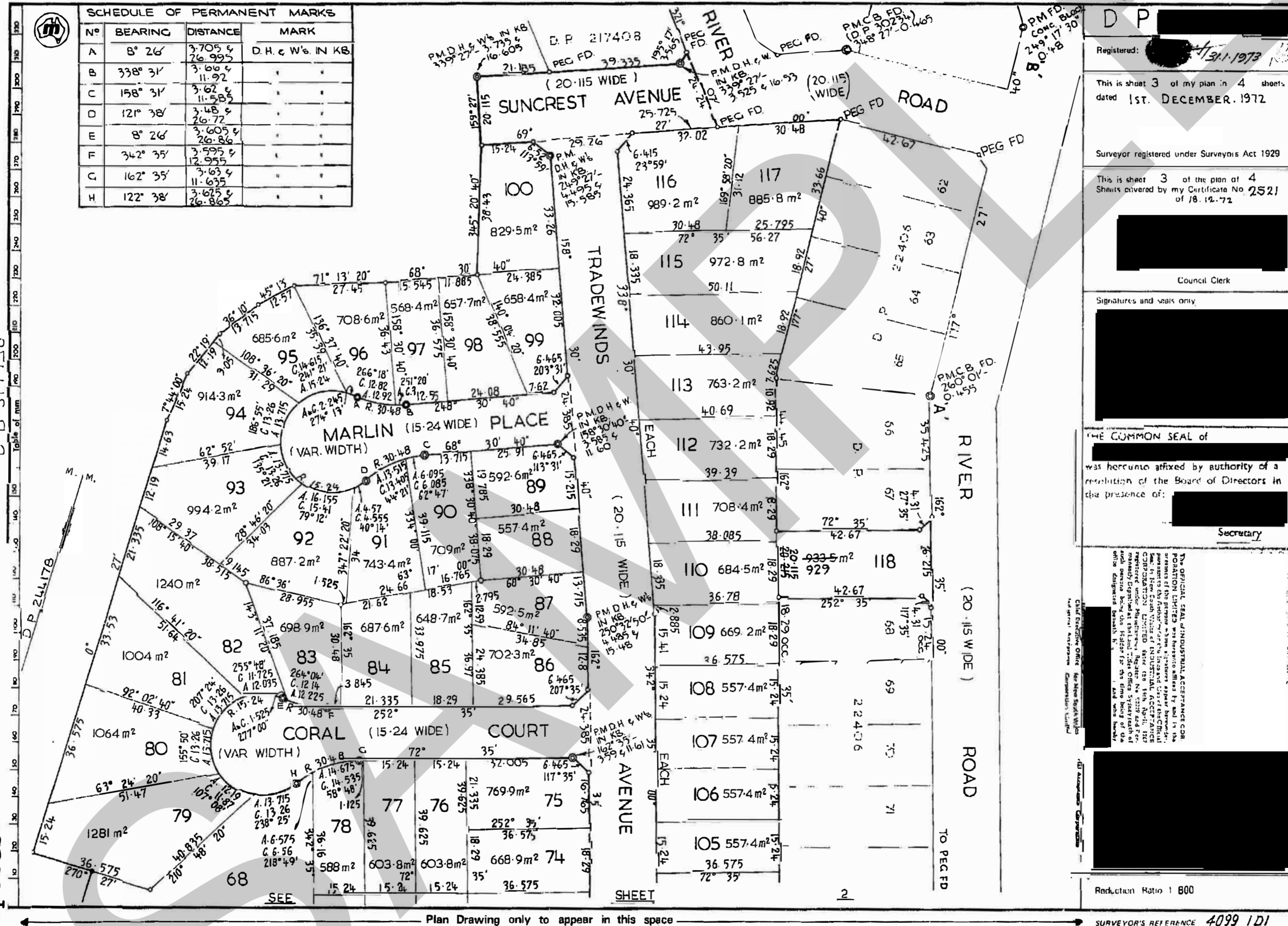

Registered: [Redacted] 1/31/1973

This is sheet 3 of my plan in 4 sheets dated 1st. DECEMBER. 1972

Surveyor registered under Surveyors Act 1929

This is sheet 3 of the plan of 4 Sheets covered by my Certificate No 2521 of 18. 12. 72

Council Clerk

Signatures and seals only

THE COMMON SEAL of [Redacted] was hereto affixed by authority of a resolution of the Board of Directors in the presence of: [Redacted] Secretary

Reduction Ratio 1 600

SURVEYOR'S REFERENCE 4099 1D1

I, Bruce Richard Davin, Registrar General for New South Wales, certify that this negative is a photograph made as a permanent record of a document in my custody this 23rd day of August, 1977

3

Warning :
 The following search results refer
 to NSW LRS Test data only.

These results may differ substantially
 from the current NSW LRS records.

These results must not be used for
 commercial purposes.

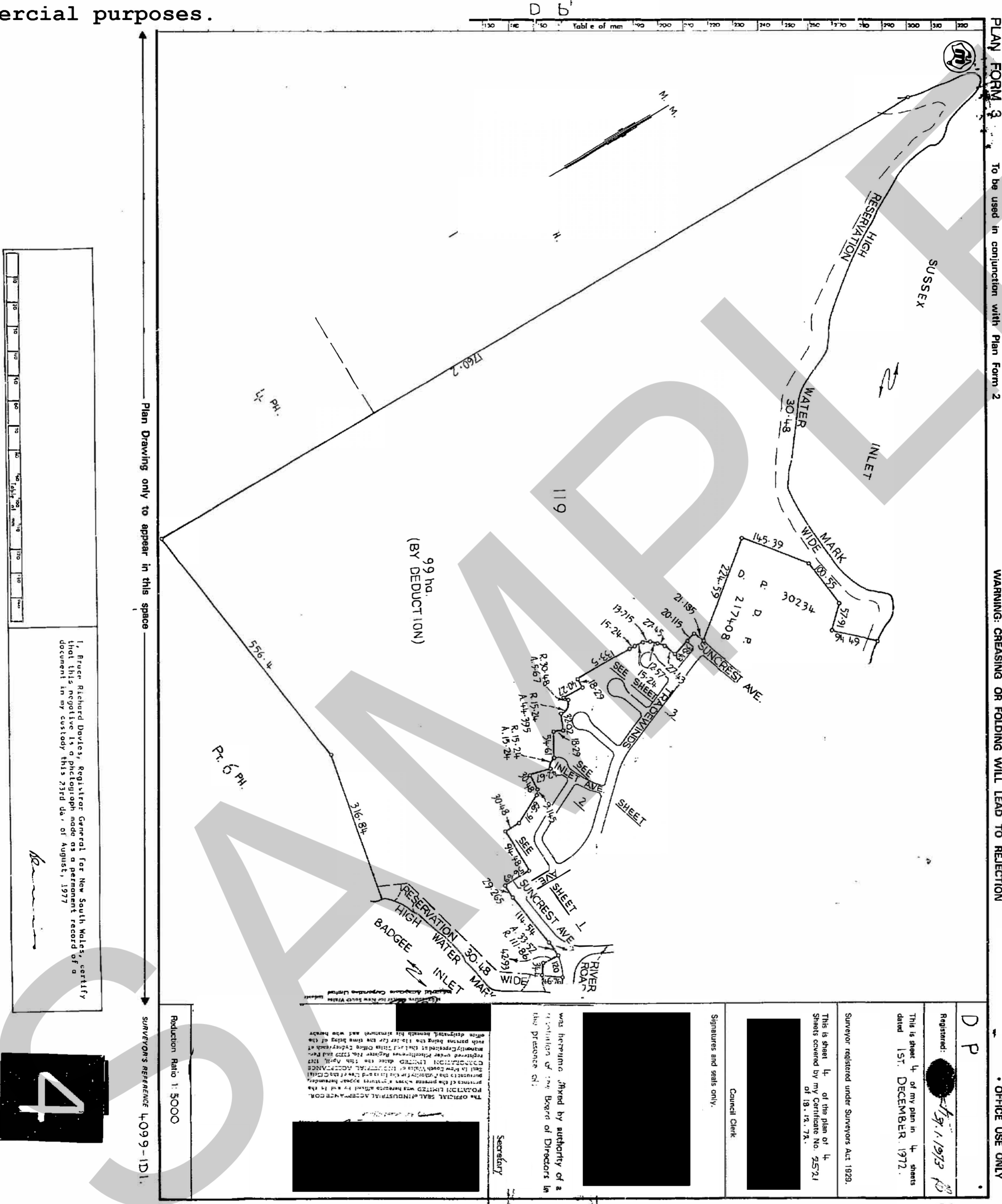

Plan Drawing only to appear in this space

I, Peter Richard Davies, Registrar General for New South Wales, certify that this negative is a photograph made as a permanent record of a document in my custody this 23rd day of August, 1977

P. R. Davies

4

Reduction Ratio 1:5000
 SURVEYOR'S REFERENCE L4099-1D1.

was heretofore filed by authority of a resolution of the Board of Directors in the presence of:

Secretary

Signatures and seals only.
 Council Clerk

Surveys registered under Surveyors Act 1929.
 This is sheet L4 of the plan of L4 sheets covered by my Certificate No. 95721 of 18. 12. 74.

Registered: *P. R. Davies*
 This is sheet L4 of my plan in L4 sheets dated 15th DECEMBER 1972.

Office Use Only
 D P