

HELD BY LANDGATE
IN DIGITAL FORM ONLY

VER	AMENDMENT	AUTHORISED BY	DATE

TOTAL AREA OF NOTICE - abt. 6.46ha

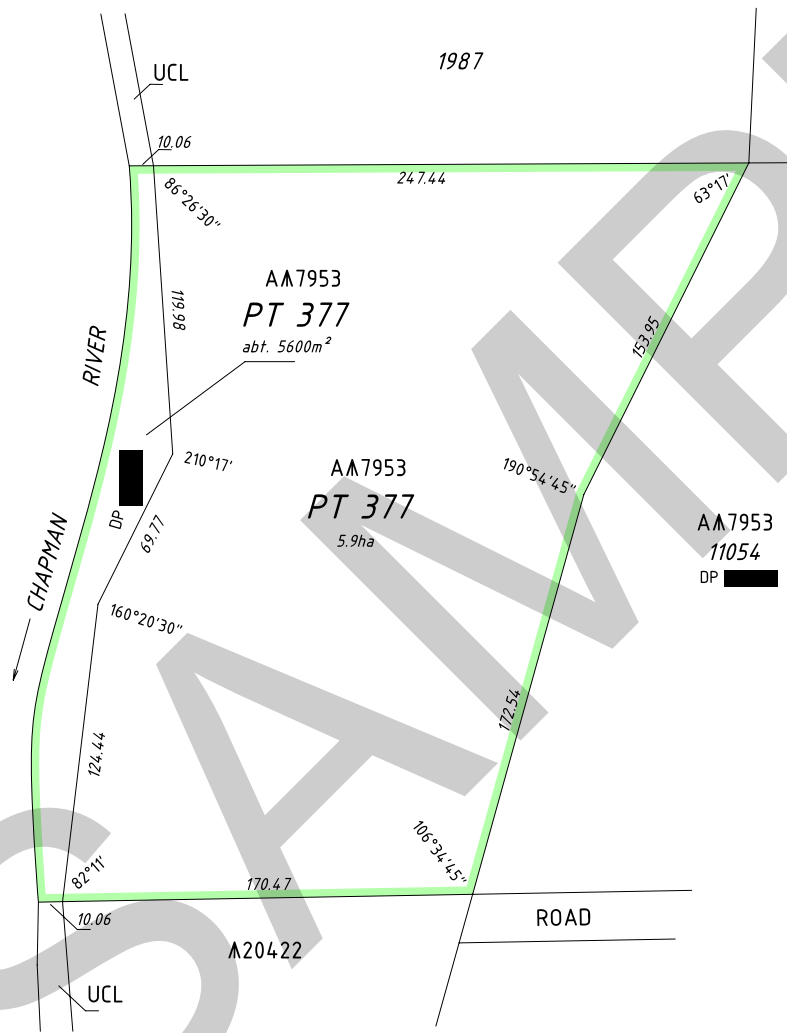

WATERLINES SHOWN HEREON DO NOT NECESSARILY DEPICT AN EXACT CADASTRAL BOUNDARY

TYPE	CROWN
PURPOSE	STATUTORY
PLAN OF	NOTICE OF INTENTION TO TAKE NATIVE TITLE ACT (COMMONWEALTH) 1993 LAND ADMINISTRATION ACT 1997

DISTRICT	VICTORIA	FORMER TENURE
TOWNSITE		
TRIM FILE	20155-2011	
LOCAL AUTHORITY	SHIRE OF CHAPMAN VALLEY	
LOCALITY	NANSON	

REFERENCE	INDEX
RDL FILE: 10378-1901/02 JOB: 060147	

SCALE @A3: ALL DISTANCES ARE IN METRES	1:2000	
---	--------	--

SUBJECT TO SURVEY
NOT FOR ALIENATION PURPOSES

LODGED	TYPE OF VALIDATION	SURVEY FIRM
DATE: 27.3.2013	FULL AUDIT: PWK	DATE: 19.3.2013
FEE PAID: N/A	LEGAL COMPONENT:	
ASSESS No: N/A	CERTIFIED CORRECT: 28/03/2013 Lead Consultant: [redacted]	

LEGEND



DEPOSITED PLAN

SHEET 1 OF 1 VERSION 1